

context



mission

Resitch the Network

Connect to the larger circulation / transit system and new development South of site

Activate edges of Freeway Park

Determine streetscape language of First Hill vs. Downtown, tactically integrate into lid expansion

Program the Fabric

Locate passive, active and playful spaces

Add school or civic building

Program site to accomplish overall lid sustainability goals



rendering provided by Studio 216

existing conditions

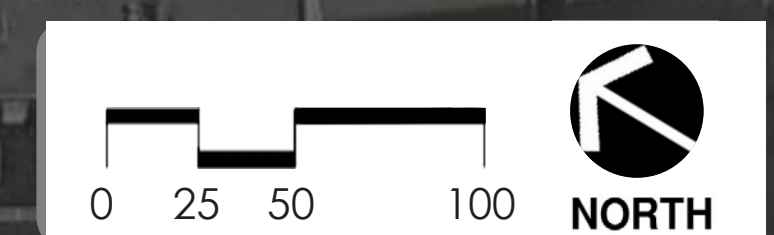

THE FREEWAY COMMONS

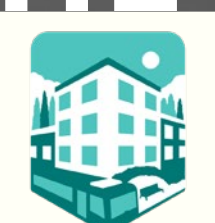

FIRST HILL
IMPROVEMENT ASSOCIATION

HNTB

HBB





1 rendering provided by Studio 216

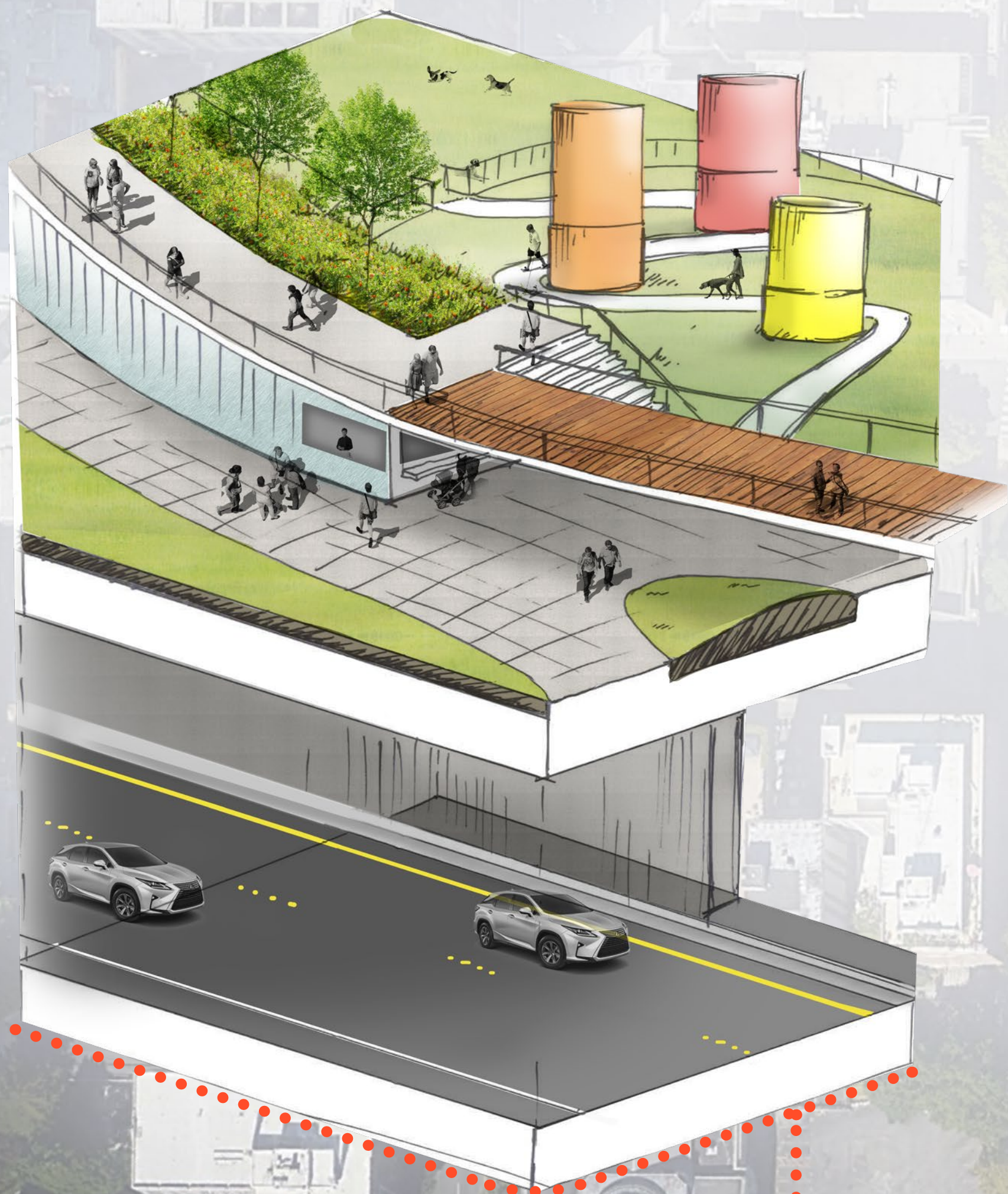

2 rendering provided by Studio 216

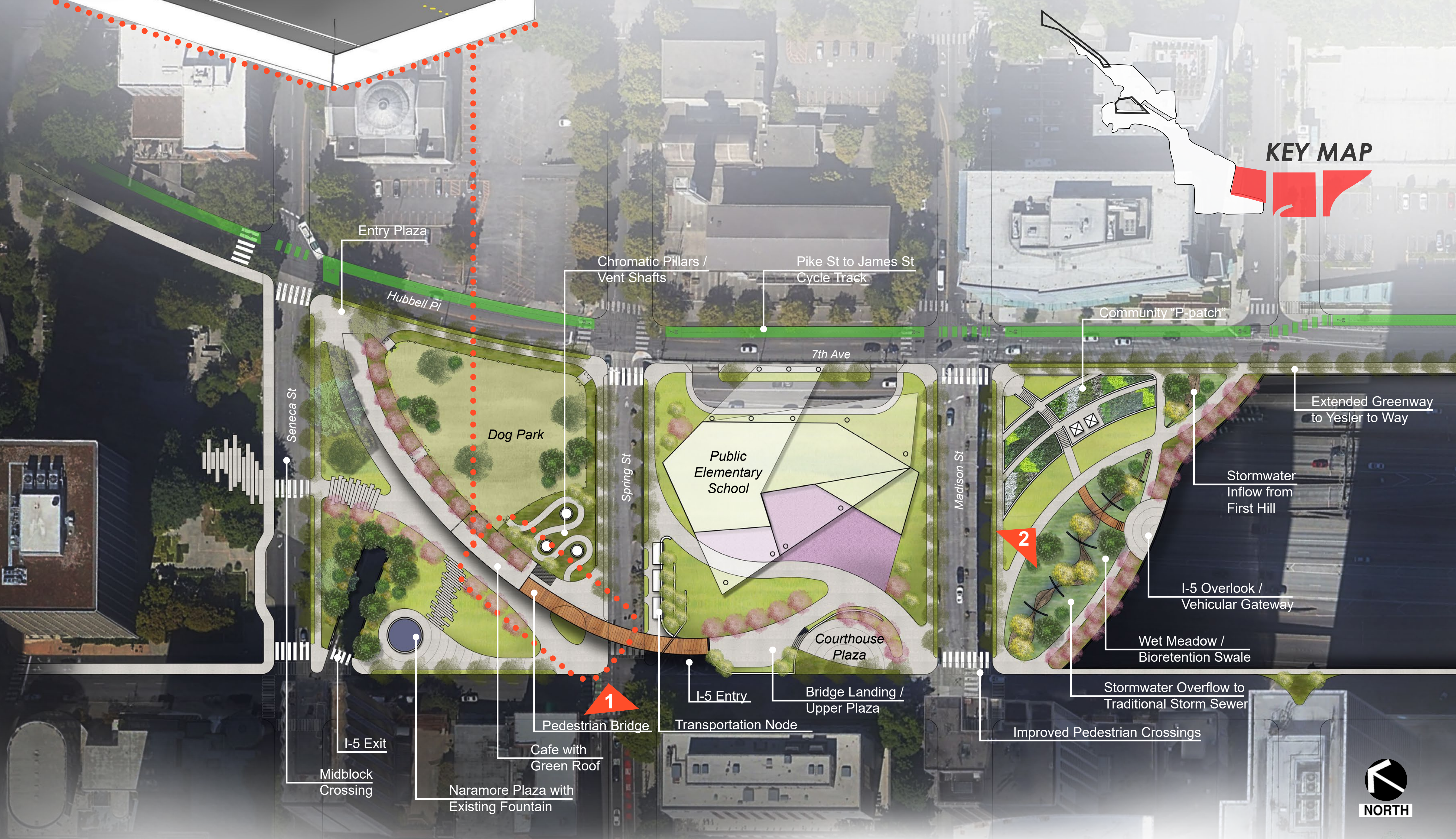

Bridge Profile



FIRST HILL
IMPROVEMENT ASSOCIATION

HNTB



CENTRAL
HILLS
TRIANGLE
COLLABORATIVE



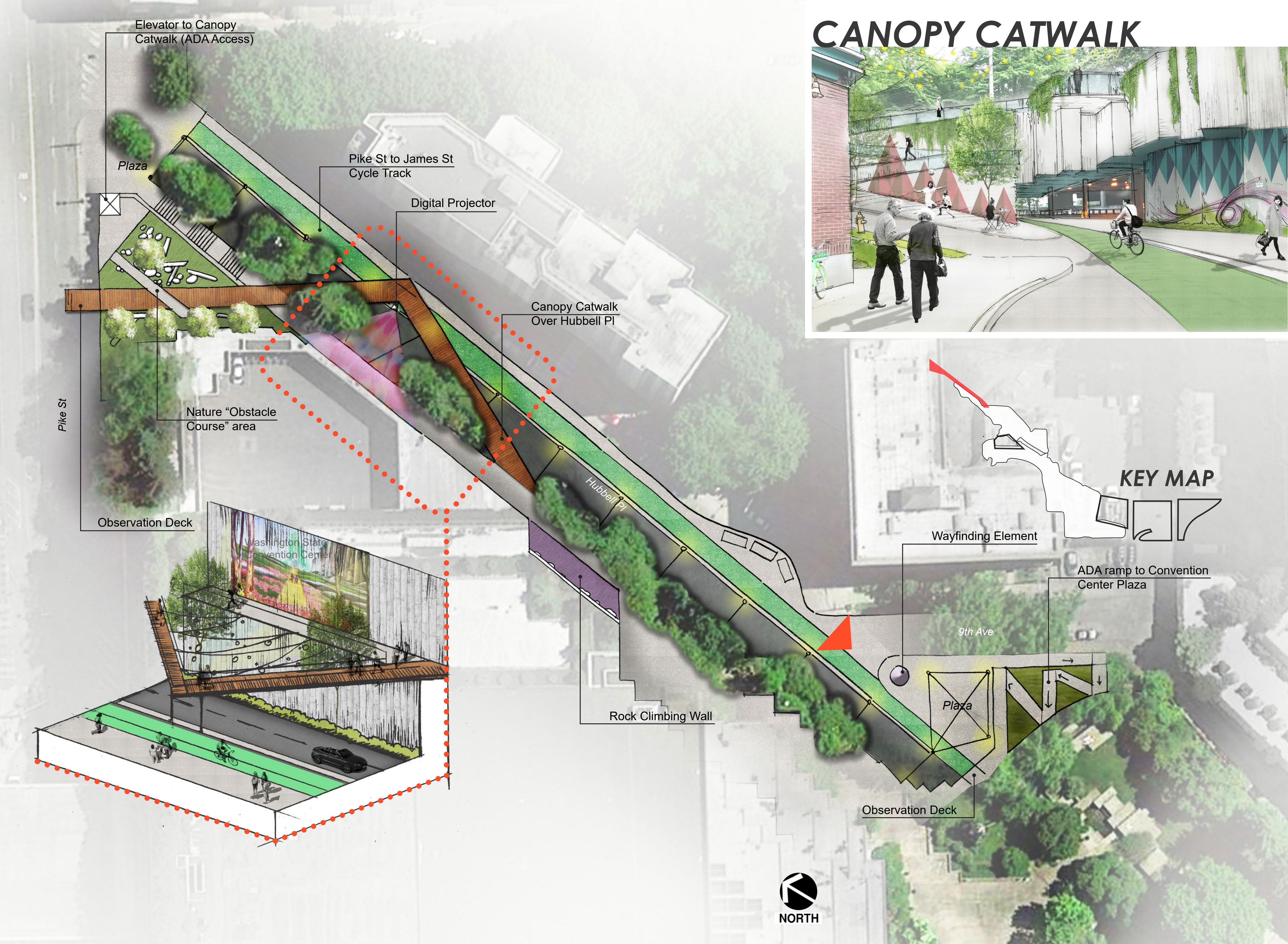

FIRST HILL
IMPROVEMENT ASSOCIATION

HNTB



REVIEW

The visualization process of the Lid I-5 project has been an important step in raising awareness and gaining support to make lidding Seattle's freeway a reality. To achieve a thorough conceptual design, we presented to peer groups and the public at various public meetings including the kickoff charrette, and the previous three collaboratives.



Kickoff Charrette



30% Collab



60% Collab



90% Collab

PROCESS

Since the kickoff charrette at the start of 2018, the S1 "Freeway Commons" project has gone through a multitude of reviews by the team internally, the Lid I-5 peer group and by the public. Each space has been designed to speak to issues affecting the adjacent neighborhoods and park. Our main goal was to add programming that would benefit existing users of Freeway Park and attract new user groups to the park. The result is a collection of passive and active spaces that address circulation, safety, education, recreation, sustainability, and noise pollution.

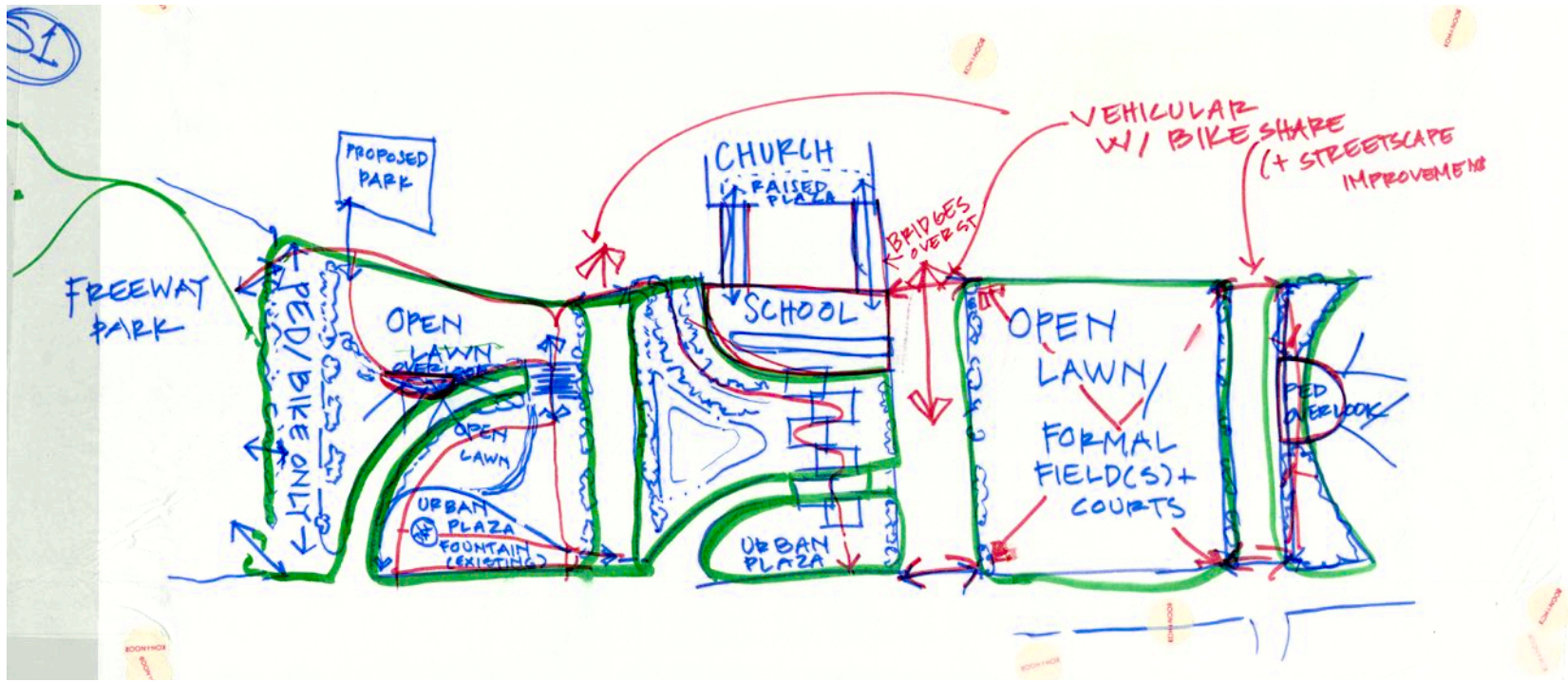

Initial Civic Green Concept



Transition from Diagram to Plan



Pedestrian Bridge Process

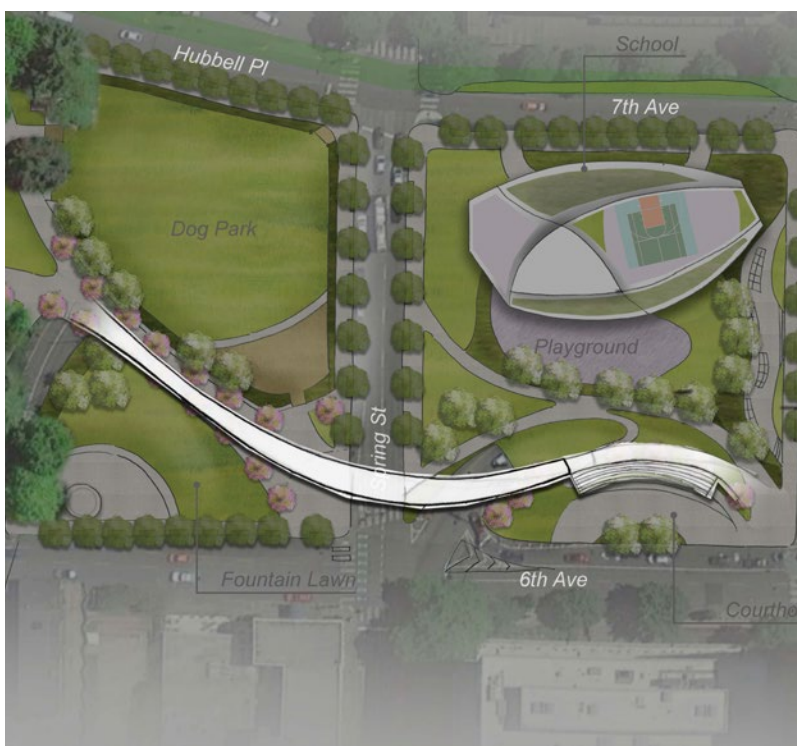

Final Civic Green Plan

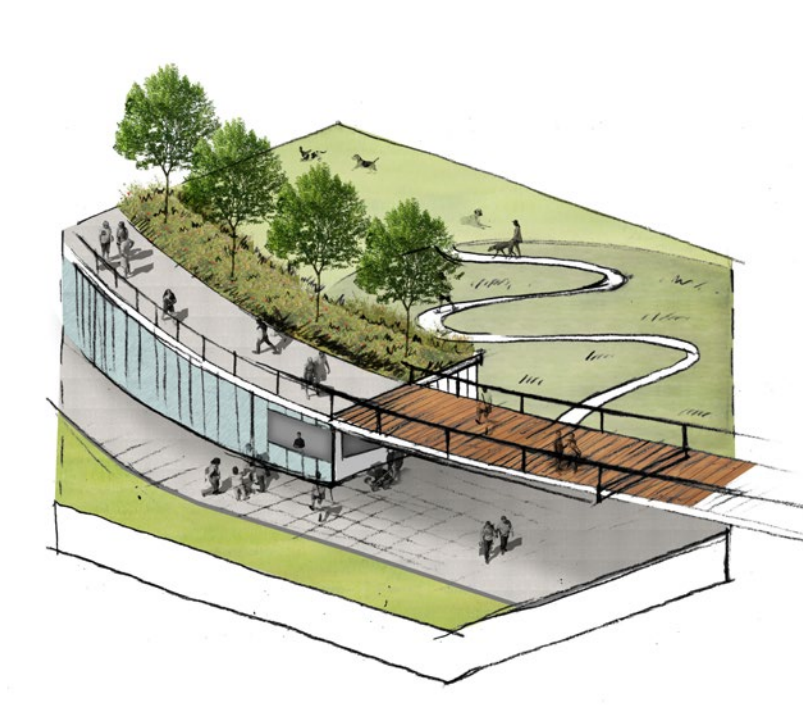

Cafe/Vent/Circulation Process

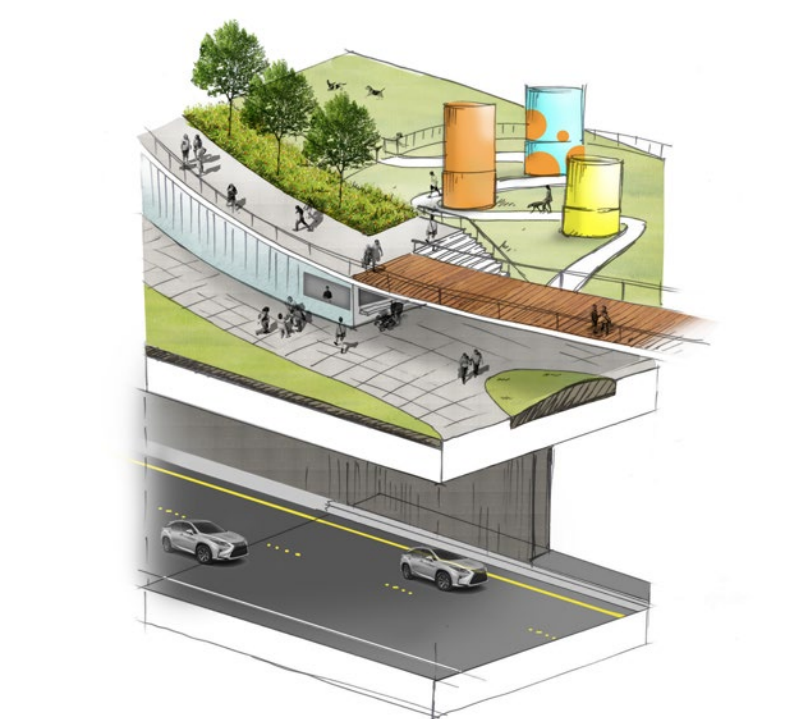

Urban Woodland Process



RESEARCH

From the beginning of the project, research became the key to developing a successful park over I-5. Between developing contextual diagrams, reviewing various reports of the surrounding areas and climbing through the lived-in box gardens South of Freeway Park, the design consistently evolved.

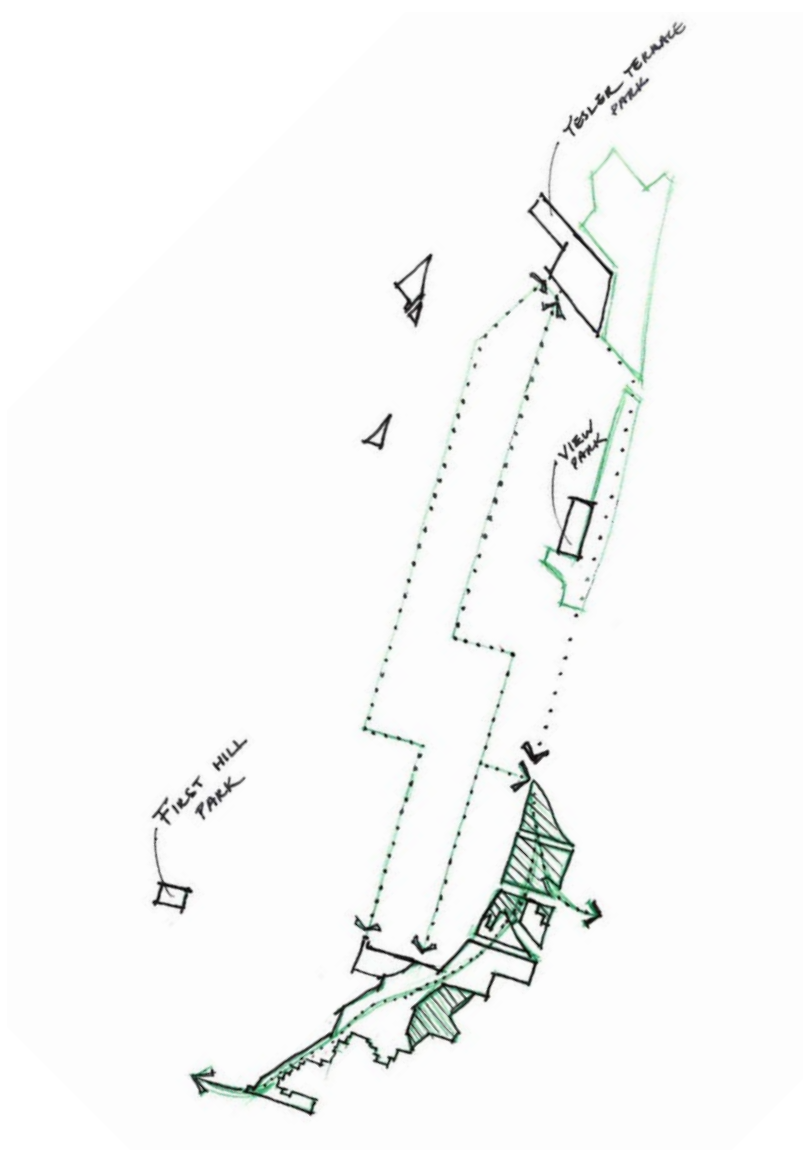

External Connections Diagram

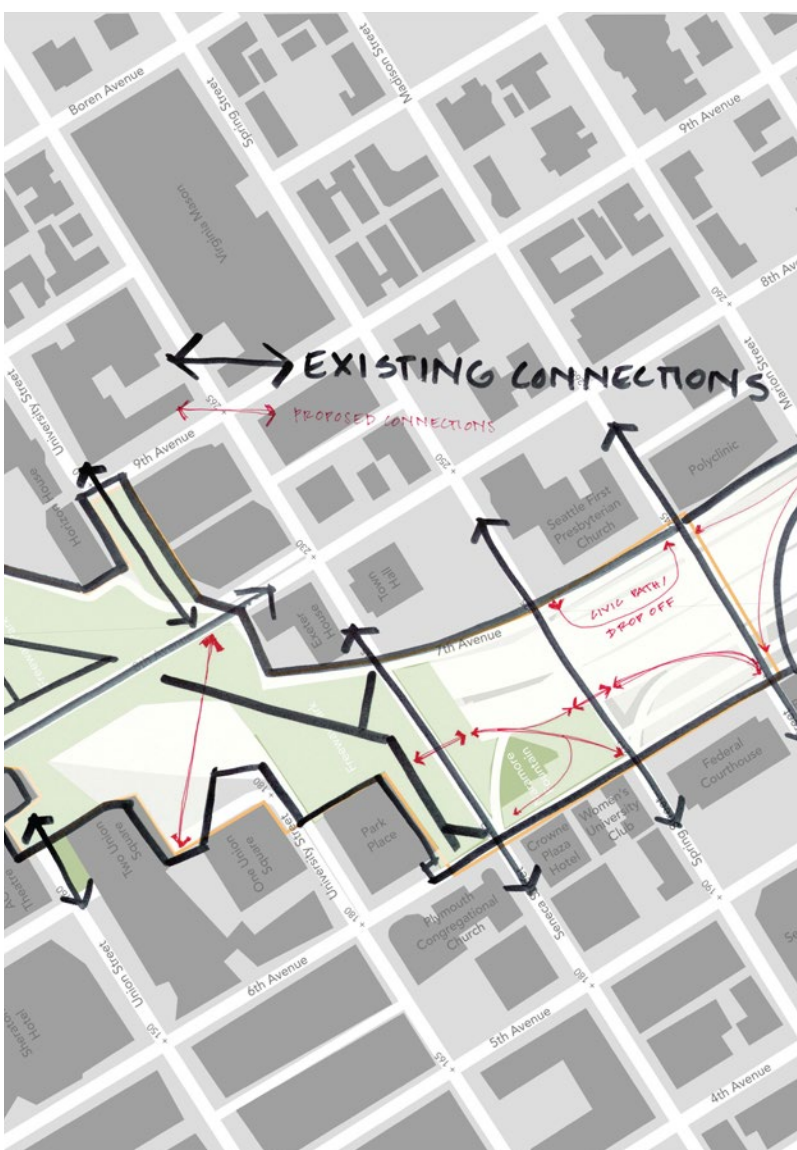

Internal Connections Diagram



Exploring the Box Gardens over I-5

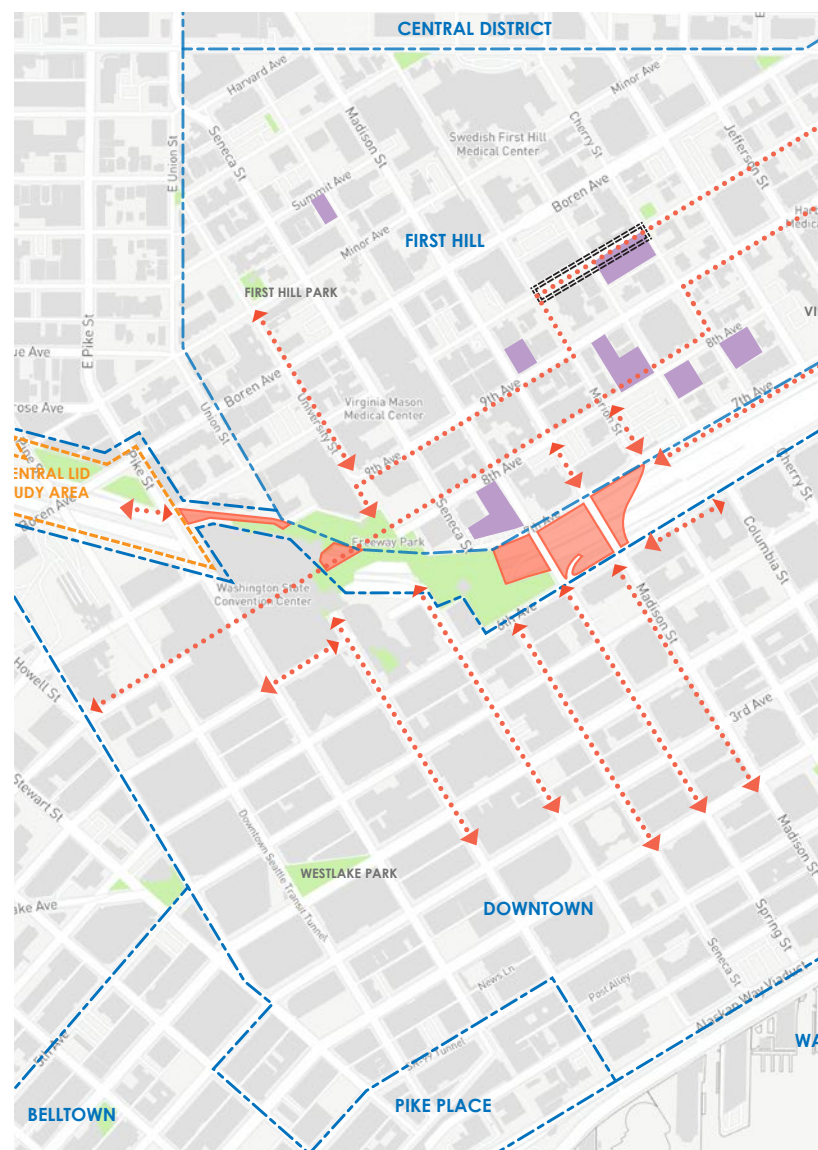

Compiled Context Diagram

TEAMWORK

Regular meetings between the lid designers and the First Hill Improvement Association helped build a framework of contextual knowledge and led to the development of a design that addresses real needs of the nearby communities.



Introductions to the Project and Team



Team Meeting at Freeway Park



Team Meeting at the Stimson-Green Mansion (Local Historical Landmark)

DESIGN PROCESS



FIRST HILL
IMPROVEMENT ASSOCIATION

HNTB

HBB

